

HL SERIES PARTS LISTING

| KEY | TP# | ITEM | KEY | TP# | ITEM |
|-----|--------|---|-----|---------|---|
| | TP-1 | CONTROL BOX COVER | | TP-76 | RUBBER GROMMET |
| | TP-4B | DX/HL CONTROL BOX | | TP-82 | REFLECTOR CENTER SUPPORT |
| | TP-5 | FLANGE GASKET | | TP-83 | STAINLESS STEEL FLEX CONNECTOR |
| | TP-9 | CONDUIT COUPLING | | TP-101 | SUB TP-223 |
| | TP-10 | CONDUIT 4" X 1/2" | | TP-104 | SUB TP-223 |
| | TP-11 | GLO-BAR IGNITOR BOX | | TP-105 | REFLECTOR END CAP |
| | TP-12 | GLO-BAR IGNITOR BOX COVER | | TP-106 | REFLECTOR CLIP |
| | TP-14 | SIGHT GLASS GASKET | | TP-108 | 5' AL-TI TUBE, PAINTED W. ONE CLAMP |
| | TP-15 | SIGHT GLASS | | TP-111 | 5' ALUM. TUBE, PAINTED W/1 CLAMP |
| | TP-16 | SIGHT GLASS WASHER | | TP-112 | 5' REFLECTOR |
| | TP-19B | WIRE HANGER | | TP-122 | GASKET FOR AIR ORIFICE & AIR COLLAR |
| | TP-20C | 120" REFLECTOR | | TP-200 | BURNER (50 MBTU/H TO 100 MBTU/H) |
| | TP-21B | TUBE CLAMP | | TP-200A | BURNER (50 TO 100 MBTU/H LP GAS) |
| | TP-26A | 10 FT. RADIANT TUBE STRAIGHT | | TP-201 | BURNER (125 MBTU/H TO 200 MBTU/H) |
| | TP-26B | 10 FT. RADIANT TUBE STRAIGHT (AL-TI) | | TP-202 | 16" BURNER TUBE W/ FLANGE |
| | TP-31B | CONTROL BOX BRACKET | | TP-204 | GAS ORIFICE - CONSULT FACTORY |
| | TP-33B | 1/2" GAS COCK | | TP-205 | GLO-BAR HOLDER |
| | TP-44 | AIR ORIFICE W/SCREEN (CONSULT FACTORY) | | TP-206 | HL END PANEL - LEFT |
| | TP-50 | GLO-BAR IGNITOR | | TP-207 | HL END PANEL - RIGHT |
| | TP-54 | BURNER BOX DIVIDER | | TP-208 | "Z" MOUNTING BRACKET |
| | TP-55A | FAN BLOWER | | TP-210 | 36E96-224 TWO STAGE GAS VALVE-NAT ASSY |
| | TP-56C | 1/4" ATMOSPHERIC TUBE (VINYL) | | TP-210P | 36E96-226 TWO STAGE GAS VALVE-LP ASSY |
| | TP-57A | 1/4" PRESSURE TUBE | | TP-211 | MARK 17X-24 CIRCUIT BOARD |
| | TP-60F | EXHT PRESSURE SWITCH - 50 TO 150 MBTU/H | | TP-211A | MARK 17U-24 CIRCUIT BOARD (REMOTE SENSE) |
| | TP60G | EXHT PRESSURE SWITCH - 175 & 200 MBTU/H | | TP-212 | 1/2" X 3" PIPE NIPPLE |
| | TP-61B | BURNER PRESSURE SWITCH - 50 - 100 MBTU/H | | TP-213 | THERMOSTAT TERMINAL STRIP |
| | TP-61C | BURNER PRESSURE SWITCH - 200 MBTU/H | | TP-214 | GLO-BAR WIRING HARNESS |
| | TP-61D | BURNER PRESSURE SWITCH - 150 & 175 MBTU/H | | TP-216 | INDICATOR LIGHT |
| | TP-65A | 66" HEAT DIFFUSER (BAFFLE) | | TP-217 | PRESSURE BARB FITTING |
| | TP-65B | 99" HEAT DIFFUSER (BAFFLE) | | TP-218 | EXHAUST PRESSURE TUBE (VINYL) |
| | TP-65C | 132" HEAT DIFFUSER (BAFFLE) | | TP-219 | 40VA TRANSFORMER |
| | TP-65D | 166" HEAT DIFFUSER (BAFFLE) | | TP-220 | STAIN. STL. TUBE CLAMP (175 & 200 MBTU/H) |
| | TP-66 | 2" X 4" OUTLET BOX | | TP-221 | GLO-BAR HOLDER GASKET |
| | TP-67 | 2" X 4" OUTLET BOX COVER | | TP-222 | FLAME ROD |
| | TP-68A | STRAIN RELIEF BUSHING | | TP-222A | FLAME ROD WIRE |
| | TP-70 | CONTROL BOX COVER GASKET (PER FOOT**) | | TP-223 | GAS MANIFOLD |

** 6' TOTAL NEEDED TO COVER OUTER EDGES OF A BURNER BOX.

HLRB OPTIONAL RELAY BOARD - SEE ACCESSORY GUIDE

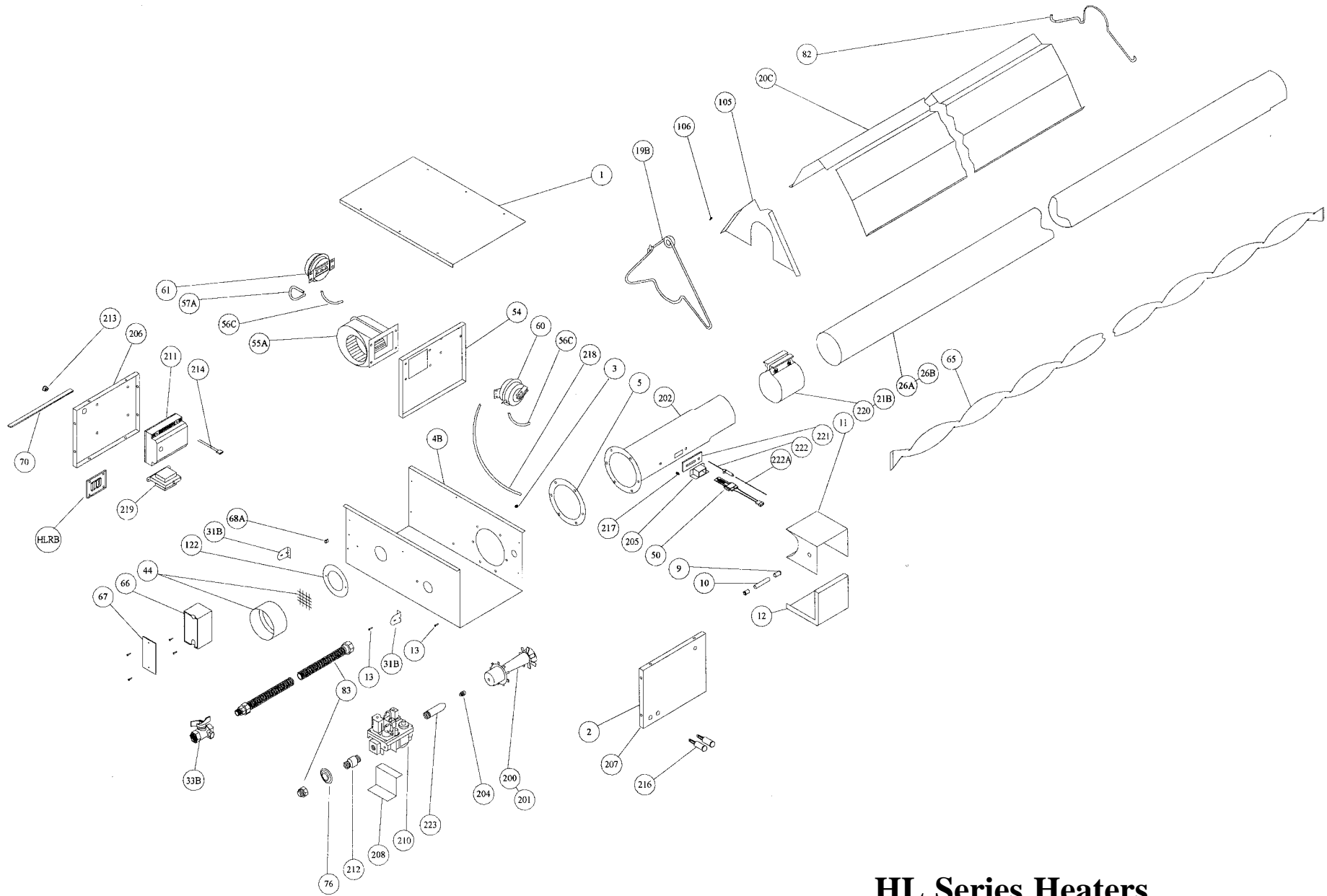

HL Series Heaters